

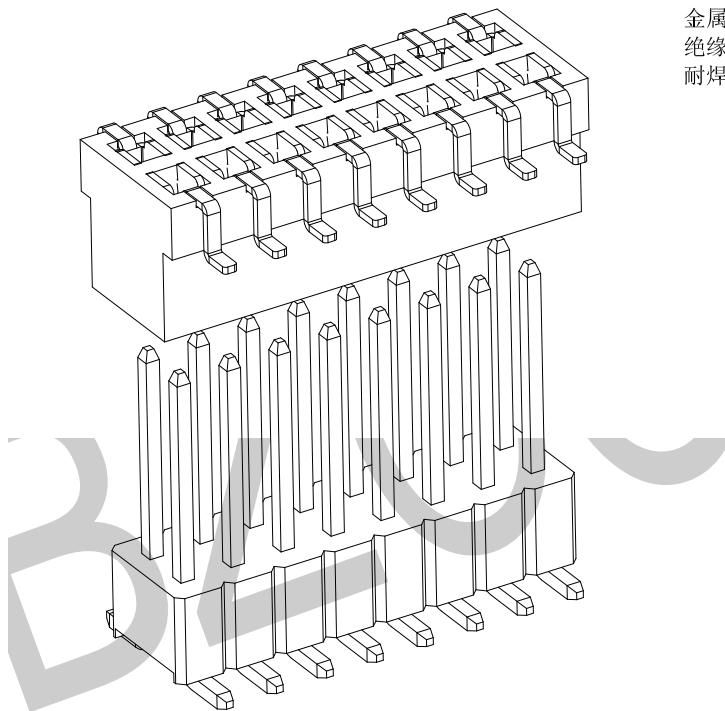

技术参数/Technical parameters

额定电流/Current Rating : 1AMP
 绝缘阻抗/Insulator Resistance : 1000MΩ Min.
 接触阻抗/Contact Resistance : 20mΩ Max.
 耐电压值/Voltage Resistance : AC 500V
 工作温度/Operating Temperature : -40℃ ~ +105℃
 金属材料/Metallic Material : Copper alloy
 金属处理/Metal Treatment : Ni (30~50u") + See description
 绝缘材料/Insulator Material : PA9T+30%GF UL94V-0
 耐焊接热/Resistance To Soldering Heat : 260° C ± 5° C 10S MAX



TOLERANCE UNLESS OTHERWISE SPECIFIED				东莞市柏洲电子有限公司 Dongguan Bzoc Electronics, Ltd			
.X± 0.35	X.*± 1.5*	APR. AX.T	TITLE: PH1.5系列排针排母				
.XX± 0.25	.X*± 1.0*	CHK. Y.L	PART NO.				
.XXX± 0.15	.XX*± 0.5*	DRA. Y.L	PROJ.	UNITS. MM	SCALE: 1:1	SHEET. 1 / 1	
CUSTOMER DRAWING							

A0	FIRST RELEASE	Y.L	2019.06.21
REV.	ECN. NO.	APR.	DATE

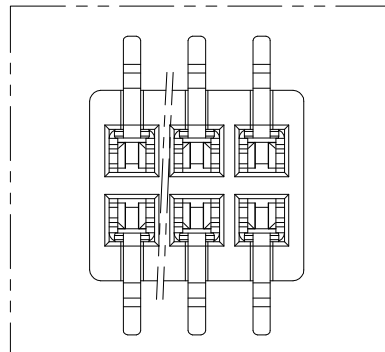
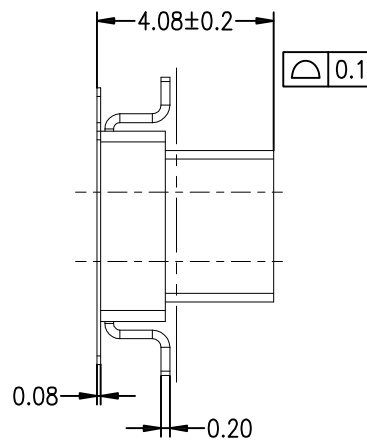
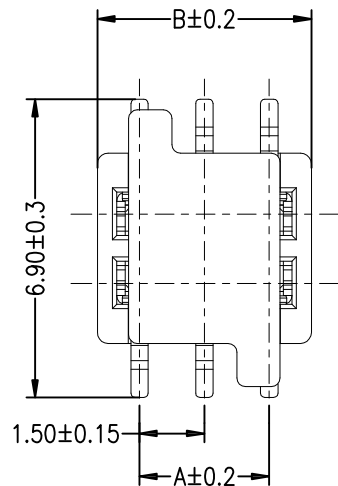

技术参数/Technical parameters

额定电流/Current Rating	:1AMP
绝缘阻抗/Insulator Resistance	:500MΩ Min.
接触阻抗/Contact Resistance	:20mΩ Max.
耐电压值/Voltage Resistance	:AC 250V
工作温度/Operating Temperature	:-40°C ~ +105°C
金属材料/Metallic Material	:Copper alloy
金属处理/Metal Treatment	:Ni(30u"~50u") + Matte-Tin(80u"~150u")
绝缘材料/Insulator Material	:LCP+30%GF UL94V-0
耐焊接热/Resistance To Soldering Heat	:260° C ±5° C 10S MAX

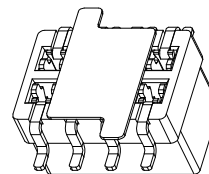

PIN.	DIM A	DIM B
2*2	1.50	3.50
2*3	3.00	5.00
2*4	4.50	6.50
2*5	6.00	8.00
2*6	7.50	9.50
2*7	9.00	11.00
2*8	10.50	12.50

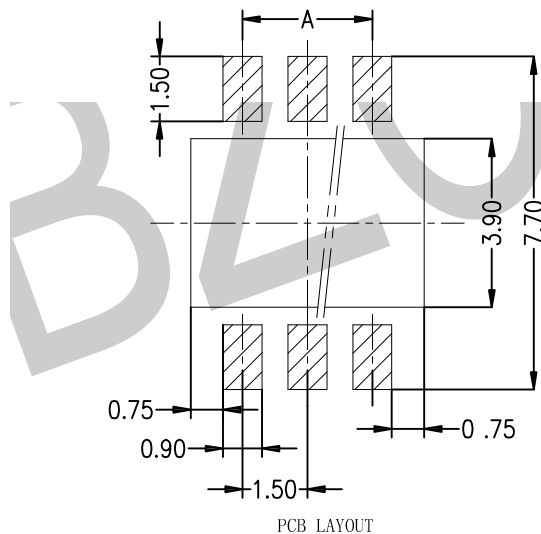
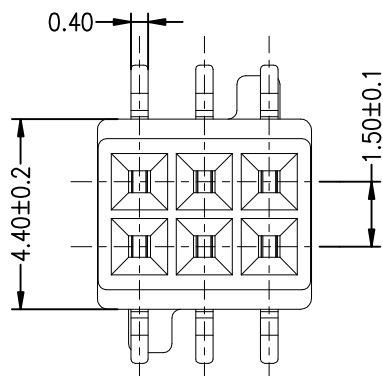
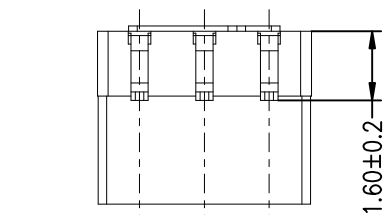
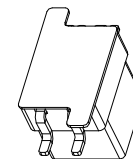

F 150-040-2XX-CVS-MT-F-RC-069-000

排母 间距1.5MM 塑胶高度:4.0MM PIN数: 202:2*2P 203:2*3p 208:2*8p

立式沉板SMT

沉板2.4MM W:6.9MM 包装方式 RC:卷装+CAP 塑胶材质: F:LCP 电镀: MT:雾锡

TOLERANCE UNLESS OTHERWISE SPECIFIED				东莞市柏洲电子有限公司 Dongguan BzooC Electronics, Ltd	
.X± 0.35	X.'± 1.5'	APR. AX.T	TITLE: FH1.5*4.0 排母 2*NP 立式沉板SMT		
.XX± 0.25	.X'± 1.0'	CHK. Y.L	PART NO.		
.XXX± 0.15	.XX'± 0.5'	DRA. Y.L	PROJ.	UNITS. MM	SCALE: 1:1
A0	FIRST RELEASE	Y.L	2019.06.21	CUSTOMER DRAWING	SHEET. 1 / 1
REV.	ECN. NO.	APR.	DATE		



PIN NO.	DIM A	DIM B	PIN NO.	DIM A	DIM B
2*2P	1.50	3.00	2*20P	28.50	30.00
2*3P	3.00	4.50	2*21P	30.00	31.50
2*4P	4.50	6.00	2*22P	31.50	33.00
2*5P	6.00	7.50	2*23P	33.00	34.50
2*6P	7.50	9.00	2*24P	34.50	36.00
2*7P	9.00	10.50	2*25P	36.00	37.50
2*8P	10.50	12.00	2*26P	37.50	39.00
2*9P	12.00	13.50	2*27P	39.00	40.50
2*10P	13.50	15.00	2*28P	40.50	42.00
2*11P	15.00	16.50	2*29P	42.00	43.50
2*12P	16.50	18.00	2*30P	43.50	45.00
2*13P	18.00	19.50	2*31P	45.00	46.50
2*14P	19.50	21.00	2*32P	46.50	48.00
2*15P	21.00	22.50	2*33P	48.00	49.50
2*16P	22.50	24.00	2*34P	49.50	51.00
2*17P	24.00	25.50	2*35P	51.00	52.50
2*18P	25.50	27.00	2*36P	52.50	54.00
2*19P	27.00	28.50			

技术参数/Technical parameters

额定电流/Current Rating	:1AMP
绝缘阻抗/Insulator Resistance	:1000MΩ Min.
接触阻抗/Contact Resistance	:20mΩ Max.
耐电压值/Voltage Resistance	:AC 500V
工作温度/Operating Temperature	:-40℃ ~ +105℃
金属材料/Metallic Material	:Copper alloy
金属处理/Metal Treatment	:Ni (30~50u") + See description
绝缘材料/Insulator Material	:PA9T+30%GF UL94V-0
耐焊接热/Resistance To Soldering Heat	:260° C ±5° C 10S MAX

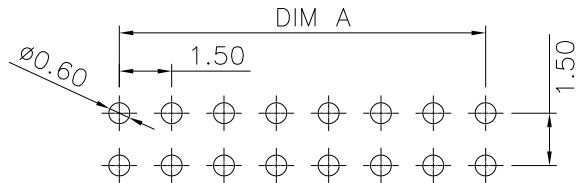
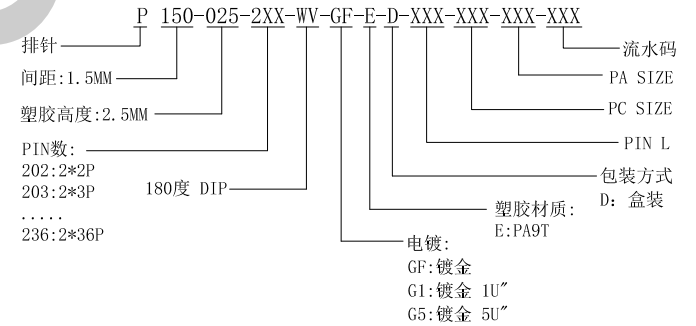
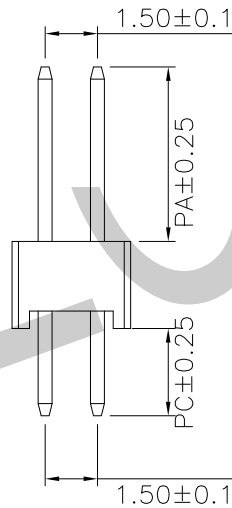
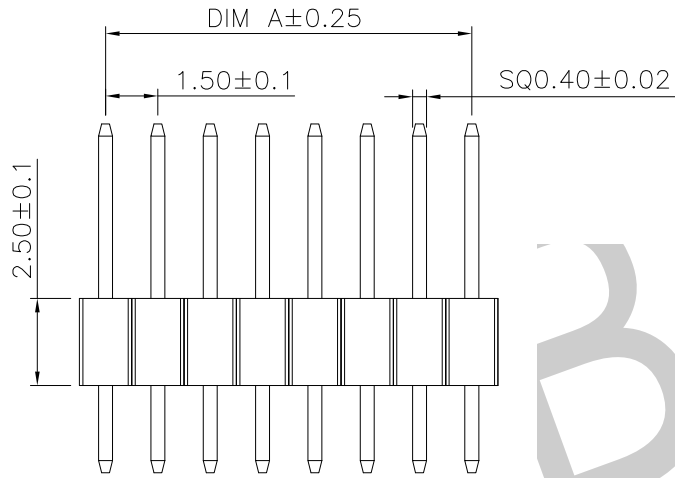
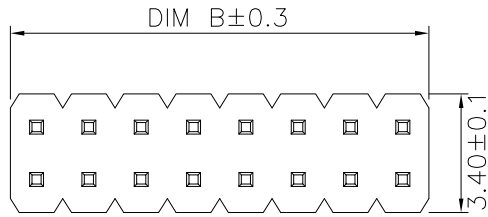

TOLERANCE: ±0.05,
RECOMMENDED PCB LAYOUT
(TOP VIEW)

A0	FIRST RELEASE	Y.L	2019.06.21
REV.	ECN. NO.	APR.	DATE

TOLERANCE UNLESS OTHERWISE SPECIFIED		APR. AX.T		TITLE: PH1.5*2.5*3.4 2*NP 180度直插系列	
.X± 0.35	X.'± 1.5'	CHK. Y.L	PART NO.		
.XX± 0.25	.X'± 1.0'	DRA. Y.L	PROJ.	UNITS. MM	SCALE: 1:1
.XXX± 0.15	.XX'± 0.5'	CUSTOMER DRAWING		SHEET. 1 / 1	

BZOC 东莞市柏洲电子有限公司
Dongguan Bzoc Electronics, Ltd



技术参数/Technical parameters

额定电流/Current Rating	: 1AMP
绝缘阻抗/Insulator Resistance	: 1000MΩ Min.
接触阻抗/Contact Resistance	: 20mΩ Max.
耐电压值/Voltage Resistance	: AC 500V
工作温度/Operating Temperature	: -40°C ~ +105°C
金属材料/Metallic Material	: Copper alloy
金属处理/Metal Treatment	: Ni (30u"-50u") + Matte-Tin (80u"-150u")
绝缘材料/Insulator Material	: PA9T+30%GF UL94V-0
耐焊接热/Resistance To Soldering Heat	: 260° C ± 5° C 10S MAX

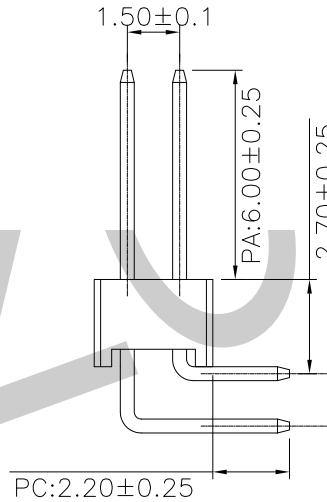
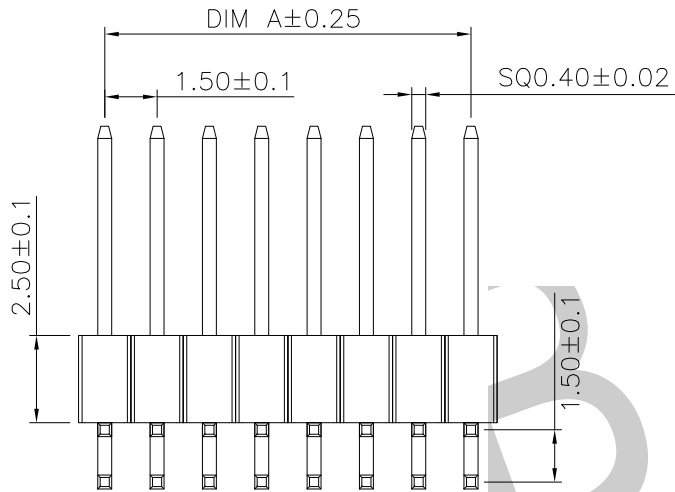
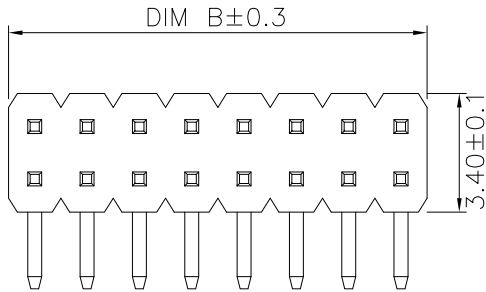

PIN NO.	DIM A	DIM B	PIN NO.	DIM A	DIM B
2*2P	1.50	3.00	2*20P	28.50	30.00
2*3P	3.00	4.50	2*21P	30.00	31.50
2*4P	4.50	6.00	2*22P	31.50	33.00
2*5P	6.00	7.50	2*23P	33.00	34.50
2*6P	7.50	9.00	2*24P	34.50	36.00
2*7P	9.00	10.50	2*25P	36.00	37.50
2*8P	10.50	12.00	2*26P	37.50	39.00
2*9P	12.00	13.50	2*27P	39.00	40.50
2*10P	13.50	15.00	2*28P	40.50	42.00
2*11P	15.00	16.50	2*29P	42.00	43.50
2*12P	16.50	18.00	2*30P	43.50	45.00
2*13P	18.00	19.50	2*31P	45.00	46.50
2*14P	19.50	21.00	2*32P	46.50	48.00
2*15P	21.00	22.50	2*33P	48.00	49.50
2*16P	22.50	24.00	2*34P	49.50	51.00
2*17P	24.00	25.50	2*35P	51.00	52.50
2*18P	25.50	27.00	2*36P	52.50	54.00
2*19P	27.00	28.50			

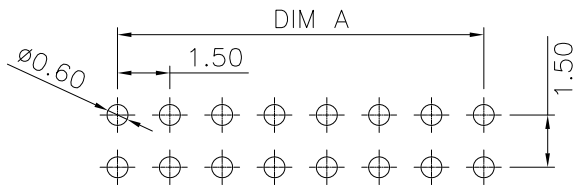

TOLERANCE: ±0.05,
RECOMMENDED PCB LAYOUT
(TOP VIEW)

排针 P 150-025-2XX-WR-MT-E-D-116146-022-060-000
 间距: 1.5MM
 塑胶高度: 2.5MM
 PIN数:
 202: 2*2P
 203: 2*3P

 236: 2*36P
 90度 DIP
 电镀:
 MT: 雾锡
 流水码 PA: 6.0MM
 PC: 2.2
 PIN L11.6/14.6MM
 包装方式 D: 盒装
 塑胶材质: E: PA9T

TOLERANCE UNLESS OTHERWISE SPECIFIED				BZOC 东莞市柏洲电子有限公司 Dongguan Bzoc Electronics, Ltd	
.X± 0.35	X.'± 1.5'	APR. AX.T	TITLE: PH1.5*2.5*3.4 2*NP 90度弯针 雾锡 9T		
.XX± 0.25	.X'± 1.0'	CHK. Y.L	PART NO.		
.XXX± 0.15	.XX'± 0.5'	DRA. Y.L	PROJ.	UNITS. MM	SCALE. 1:1
A0	FIRST RELEASE	Y.L	2019.06.21	CUSTOMER DRAWING	
REV.	ECN. NO.	APR.	DATE	SHEET. 1 / 1	

A0	FIRST RELEASE	Y.L	2019.06.21
REV.	ECN. NO.	APR.	DATE