

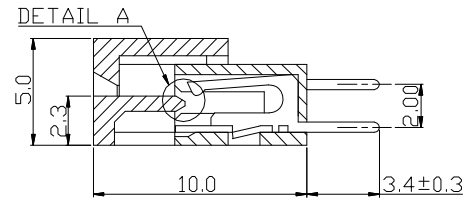

NOTES

HOUSING—PBT UL 94V-0
 TERMINAL—COPPER ALLOY
 Electrical Characteristics:
 Current rating: 0.5A AC/DC
 Voltage rating: 50V AC/DC
 Temperature range: -25°C~+85°C
 Withstand Voltage: 200V AC/Minute
 Contact Resistance: 20mΩ
 Insulation resistance: 500 MΩ
 Relative Humidity: 93%+40°C

CKT	A	B
3	9.55	5.20
4	10.80	6.45
5	12.05	7.70
6	13.30	8.95
7	14.55	10.20
8	15.80	11.45
9	17.05	12.70
10	18.30	13.95
11	19.55	15.20
12	20.80	16.45
13	22.05	17.70
14	23.30	18.95
15	24.55	20.20
16	25.80	21.45
17	27.05	22.70
18	28.30	23.95
19	29.55	25.20
20	30.80	26.45
21	32.05	27.70
22	33.30	28.95
23	34.55	30.20
24	35.80	31.45
25	37.05	32.70
26	38.30	33.95
27	39.55	35.20
28	40.80	36.45
29	42.05	37.70
30	43.30	38.95
31	44.55	40.20
32	45.80	41.45

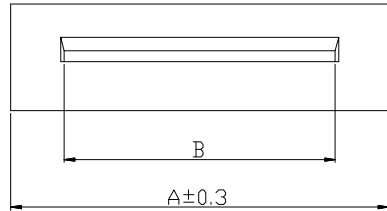

OPEN TYPE

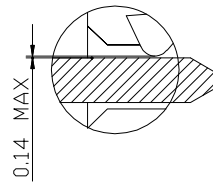
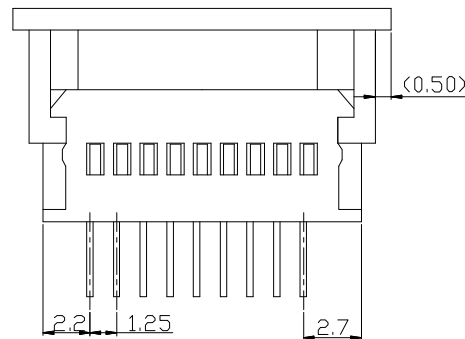

DETAIL A
CLOSE TYPE

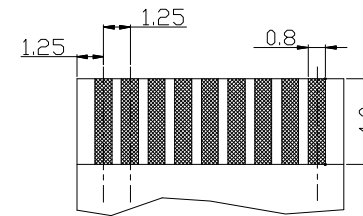

FFC/FPC DIMENSION
THICKNESS 0.3±0.05mm

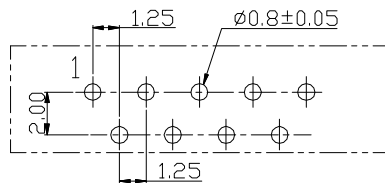

RECOMMEND PCB LAYOUT
COMPONENT SIDE

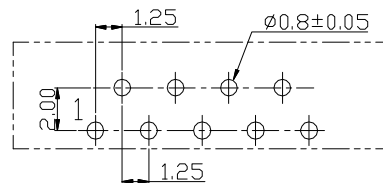

RECOMMEND PCB LAYOUT
COMPONENT SIDE

FP 125-050-0XX-WV-SN-A-T-DSX-XXX

间距: 1.25MM
 塑胶高度: 5.0MM
 PIN数:
 003: 3PIN
 004: 4PIN

 032: 32PIN

流水号
 分类
 DSZ: 带锁正脚
 DSF: 带锁反脚

包装方式
 T: 管装

塑胶材质:
 A: PBT

电镀: SN: 镀锡

直脚: WV

TOLERANCE UNLESS OTHERWISE SPECIFIED		BZOOC		东莞市柏洲电子有限公司 Dongguan Bzooc Electronics, Ltd	
.X± 0.35	X.'± 1.5'	APR.	AX.T	TITLE: 1.25FPC 带锁直插	
.XX± 0.25	.X'± 1.0'	CHK.	Y.L	PART NO.	
.XXX± 0.15	.XX'± 0.5'	DRA.	Y.L	PROJ.	UNITS. MM SCALE: 1:1
A0	FIRST RELEASE	Y.L	2019.06.21	CUSTOMER DRAWING	SHEET. 1/1
REV.	ECN. NO.	APR.	DATE		